

Specification Sheet:

HTT-425-A1S-100

HTT-425-A1S-1000

SHEET # 940-2T550

DESCRIPTION

Designed to mount directly on Allen-Bradley 1326AB-A4 servomotors, these transducer simplify resolver position feedback from these motors. These transducers are absolute position sensors that encode 100 or 1000 turns. Outside connections to the transducer are made through a watertight MS connector. These transducers connects to AMCI equipment using our standard CML cable. The transducer meets NEMA rating 13 when properly installed. A coupler to a 0.375" diameter shaft is included, and two access holes are available to make shaft coupling an easy task.

Because the HTT-425-A1S-(x) is an absolute sensor it cannot "lose counts" when rotating as an incremental transducer can. If the transducer appears to be losing counts when operating, the usual cause is a shaft slipping in the coupler.

DIMENSIONAL DRAWING

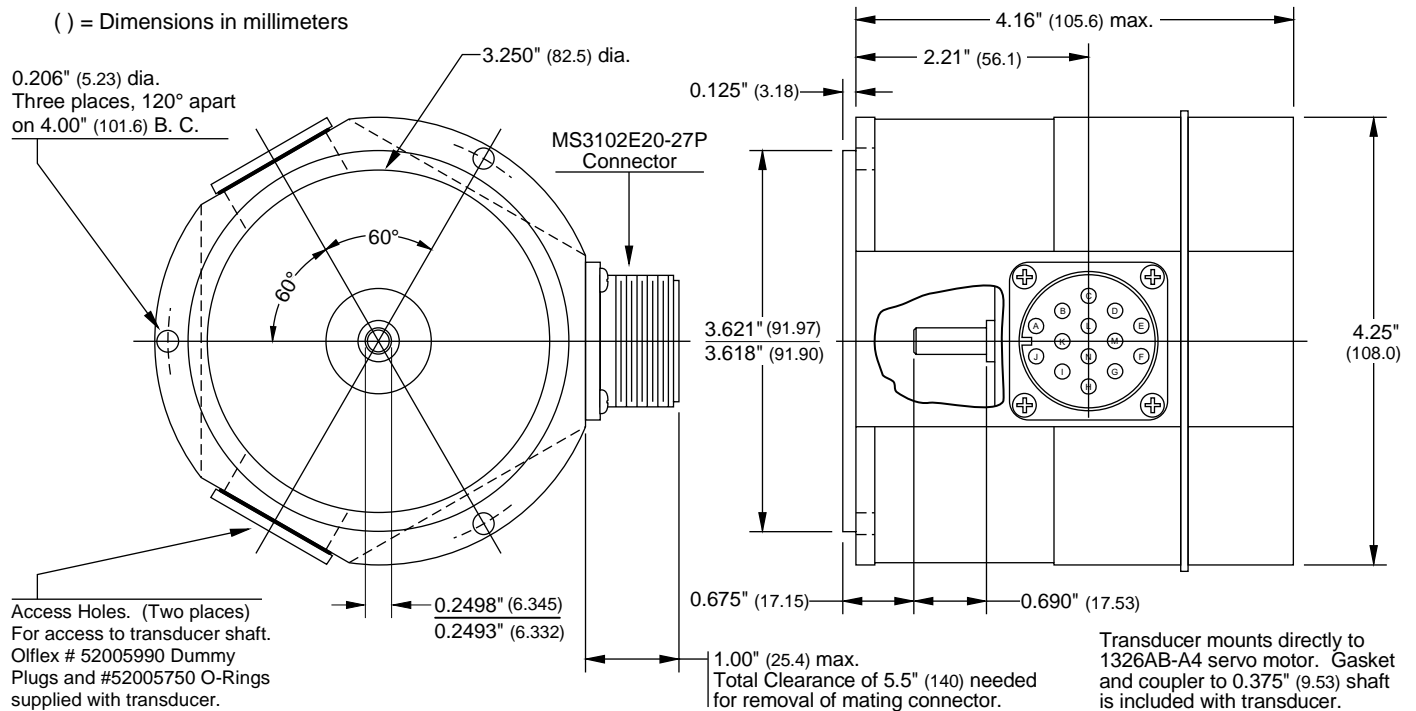

FINE RESOLVER

- R1: (RED/WHT)
- R2: (BLK/WHT)
- S3: (BLACK)
- S1: (RED)
- S2: (YELLOW)
- S4: (BLUE)

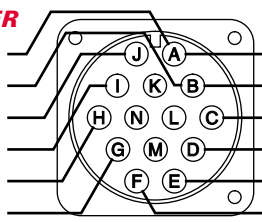

COARSE RESOLVER

- R1: (RED/WHT)
- R2: (BLK/WHT)
- S4: (BLUE)
- S2: (YELLOW)
- S1: (RED)
- S3: (BLACK)

Female Mating Connector	AMCI Part #
MS3106A20-27S	STRAIGHT MS-20
MS3108A20-27S	RT. ANGLE MS-22
MS3106F20-27S	WATERTIGHT MS-201

HTT-425-A1S Specification Sheet

SPECIFICATIONS

ENVIRONMENTAL

Shock: 50 g's for 11 mSec
Vibration: 20 g's to 2000 Hz
Operating Temp: -20 to 125°C
Enclosure: NEMA 13
Anodized Aluminum Body
303 Stainless Steel Shaft

ELECTRICAL

Input Voltage: 7.0 V
Input Freq: 5000 Hz
Primary: Rotor
Input Current: 17.0 mA Max.
Output Voltage: 6.65 V Nom.
Trans. Ratio (TR): $0.95 \pm 5\%$
Accuracy: 5 min. (max error)

MECHANICAL

Shaft Loading: Radial: 40 lbs. max.
10 lbs. max. working
Axial: 20 lbs. max.
5 lbs. max. working
Starting Torque: 1.5 oz.in. @ 25°C
Moment of Inertia: 6.00×10^{-4} oz-in-sec² max.
Weight: 4 lbs

SHAFT COUPLER DIMENSIONS

The included shaft coupler is for motors with a 0.375" diameter shaft. The coupler is manufactured by Helical and their part number is MCAC100-12-8.

Permitted
Axial Motion: ± 0.010 "
Angular Misalignment: 5 degrees
Offset: 0.030"

Torques
Non-reversing: 10 lb-in
Shock: 5 lb-in
Momentary: 20 lb-in

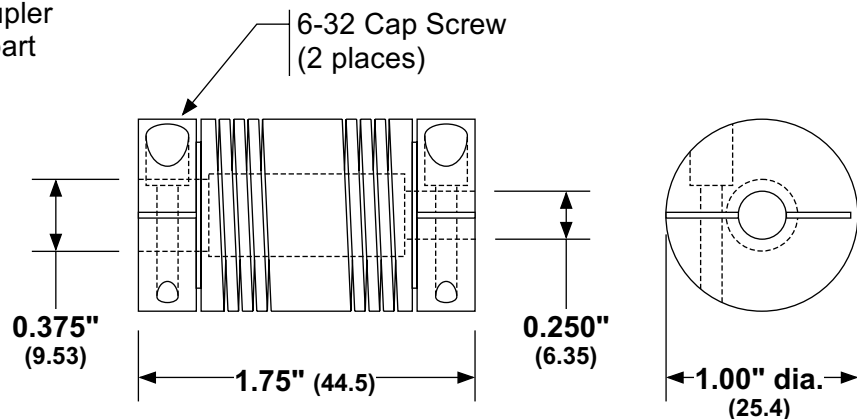

FOR MORE INFORMATION

If you need more information on the HTT-425-A1S-100 or HTT-425-A1S-1000 use these three resources:

- * If you have internet access, check our website at <http://www.amci.com>. We've worked hard to make our site the repository of information you need to specify and use AMCI products. New product news, product specifications, compatibility tables, application notes, and PDF manuals are all available 24 hours a day.
- * You can also call AMCI for sales or technical support at (860) 585-1254 from 8AM to 5PM EST, Monday through Friday. An applications engineer will be available to assist you.
- * Finally, you can e-mail us at sales@amci.com or techsupport@amci.com.